

Hyde Park

Speakers' Corner Restoration and Interpretation

The Royal Parks will soon be further improving Speakers' Corner by installing paving, bespoke fencing and tree planting, all part of a masterplan for the space.

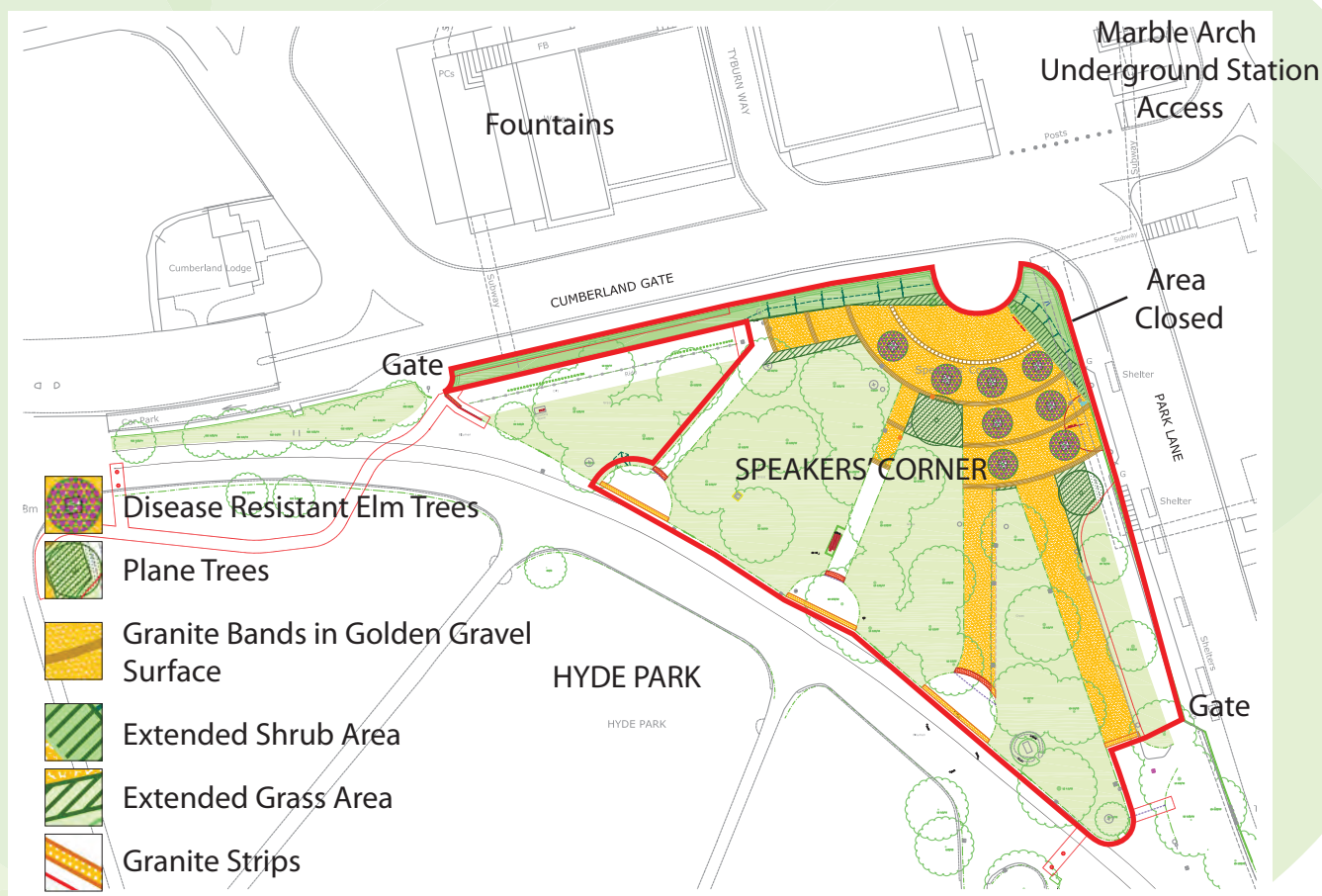

Please be aware that due to improvement works the area within the red line will be closed and sections of paths will be restricted at times. Works will take place from January to April 2014. The diversion routes for cyclists, horses and pedestrians will be indicated.

We apologise for any inconvenience this may cause.

PLEASE NOTE: there will be times when access may be restricted and there will be larger vehicle movements in the park. The Royal Parks are making every effort to keep this to a minimum during implementation. We wish to ensure the safety and enjoyment of our visitors.

Should you have any queries or comments regarding the works please contact the Hyde Park team at Hyde@royalparks.gsi.gov.uk or contact our main switchboard **0300 061 2000**